

Yealink

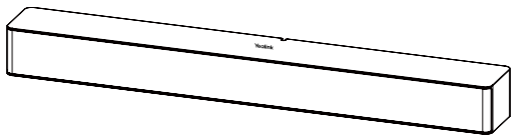

Unboxing Video

Video Conferencing Soundbar MSpeaker Pro



English | Deutsch | Français | Español | Nederlands

Quick Start Guide (V1.0)

CONTENT

English.....	1
Deutsch.....	5
Français.....	9
Español.....	13
Nederlands.....	17

Package Content

EN

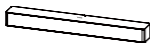

MSpeaker Pro



(L270*W50.0*T2.5mm)
Wall Mount Bracket



× 2

Φ6 * 30 mm, white, Polyamide



× 2

T4*30 FAHOZN3+ (+)



(3.0m, 9.84ft)
CAT5e UTP
(RJ45 - RJ45) Cable



Quick Start Guide

 We recommend that you use the accessories provided or approved by Yealink. The use of unapproved third-party accessories may result in poor performance.

MSpeaker Pro Connection

• Single MSpeaker Pro connection

Connect the MSpeaker Pro to the VCH port of the UVC84 / UVC86 / SmartVision 80 / AVHub via an Ethernet cable as the audio output device. The following is an example of connecting to the SmartVision 80.

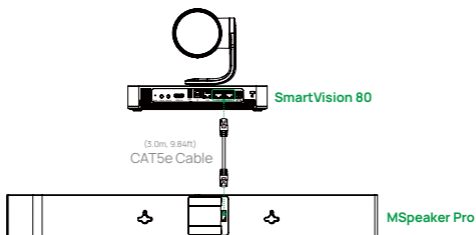

• Multiple MSpeaker Pro connection

Connect MSpeaker Pro to the VCH port of the AVHub/SmartVision 80 via Ethernet cable.

Connect to SmartVision 80

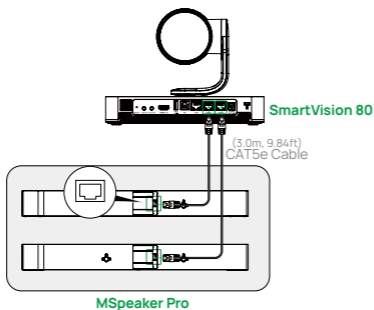

 To connect more than two MSpeaker Pro devices, SmartVision 80 requires an extra PoE/PoE+ switch for the surplus devices.

Connect to AVHub

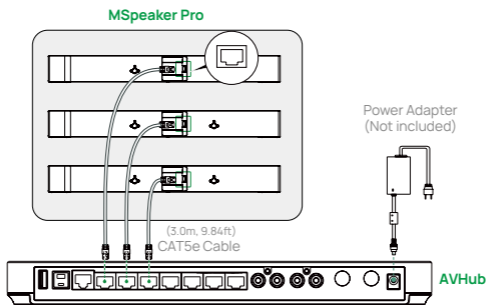

 To connect more than three MSpeaker Pro devices, AVHub requires an extra PoE/PoE+ switch for the surplus devices.

MSpeaker Pro Installation

- **Put on a Flat Surface**

You can put the MSpeaker Pro on the conference table.

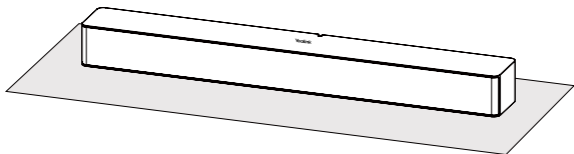

- **Mount on a Wall**

Horizontal installation

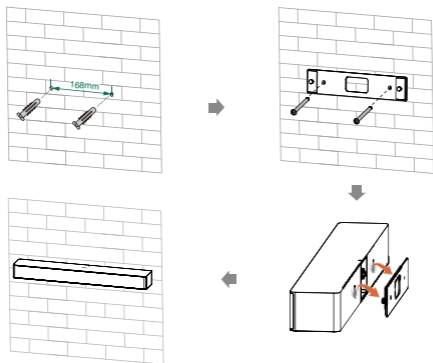

Vertical installation

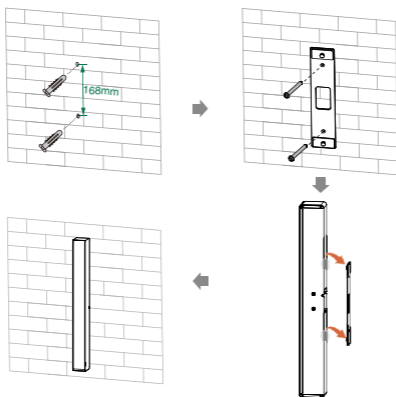

LED Indicator Instruction

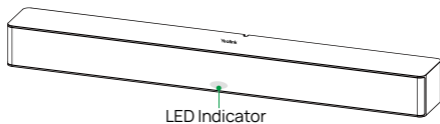

LED Status	Description
Off	The device is powered off.
Solid green	The device is active.
Red and green flashing alternately	The device is in initialling.

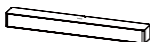

MSpeaker Pro



(L270* B 50,0* T 2,5mm)

Wandmontagehalterung



× 2

Φ 6 * 30 mm, weiß, Polyamid



× 2

T4*30 FAHOZN3+ (+)



(3,0m, 9,84ft)

CAT5e UTP
RJ45 - RJ45 Kabel



Kurzanleitung

 Wir empfehlen Ihnen, das von Yealink bereitgestellte oder autorisierte Zubehör zu verwenden. Die Verwendung von nicht autorisiertem Zubehör von Drittanbietern kann zu einer schlechten Leistung führen.

MSpeaker Pro Verbindung

• Einzelne MSpeaker Pro Verbindung

Verbinden Sie den MSpeaker Pro über ein Ethernet-Kabel mit dem VCH-Port des UVC84 / UVC86 / SmartVision 80 / AVHub als Audioausgabegerät. Das folgende ist ein Beispiel für die Verbindung mit dem SmartVision 80.

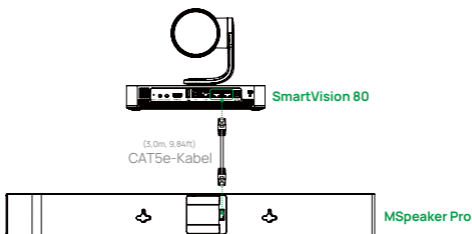

• Mehrere MSpeaker Pro-Verbindungen

Verbinden Sie den MSpeaker Pro mit dem VCH-Port des AVHub/ SmartVision 80 über ein Ethernet-Kabel.

Mit SmartVision 80 verbinden

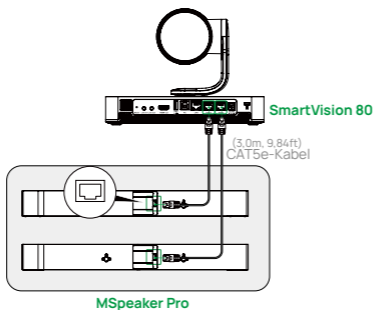

 Um mehr als zwei MSpeaker Pro-Geräte zu verbinden, benötigt SmartVision 80 einen zusätzlichen PoE/PoE+-Switch für die überschüssigen Geräte.

Mit AVHub verbinden

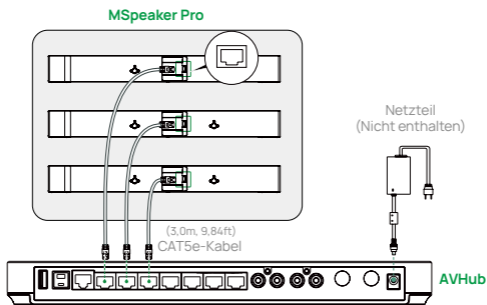

 Um mehr als drei MSpeaker Pro-Geräte zu verbinden, benötigt der AVHub einen zusätzlichen PoE/PoE+-Switch für die zusätzlichen Geräte.

MSpeaker Pro Installation

- **Aufstellung auf einer flachen Oberfläche**

Du kannst den MSpeaker Pro auf den Konferenztisch stellen.

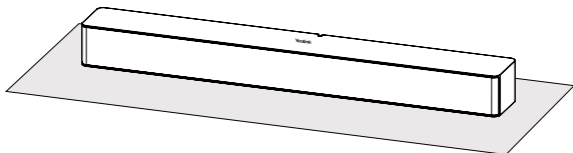

- **Wandmontage**

Horizontale Installation

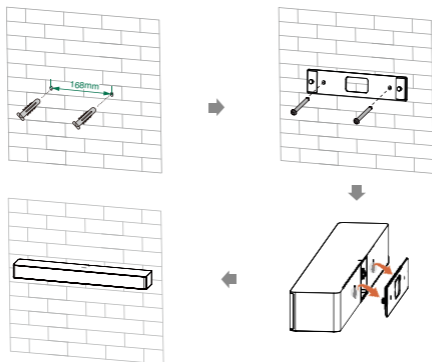

Vertikale Installation



LED-Anzeigenleitung

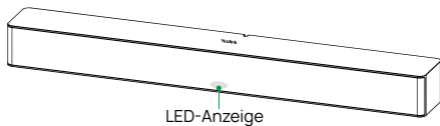

LED-Status	Beschreibung
Off	Die Gerät ist ausgeschaltet.
Dauerhaft grün	Das Gerät ist aktiv.
Rot und grün blitzen abwechselnd	Das Gerät wird initialisiert.

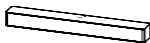

MSpeaker Pro



(L270*150.0*T2.5mm)

Support mural



× 2

Φ6 * 30 mm, blanc, polyamide



× 2

T4*30 FAHOZN3+ (+)



(3.0m, 9.84ft)

CAT5e UTP

Câble (RJ45 - RJ45)



Guide de démarrage rapide

 Nous vous conseillons d'utiliser les accessoires fournis ou approuvés par Yealink. Les accessoires tiers non approuvés peuvent entraîner de moins bonnes performances.

MSpeaker Pro Connection

• Connexion unique MSpeaker Pro

Connectez le MSpeaker Pro au port VCH du UVC84 / UVC86 / SmartVision 80 / AVHub via un câble Ethernet en tant que dispositif de sortie audio. L'exemple suivant montre comment se connecter au SmartVision 80.

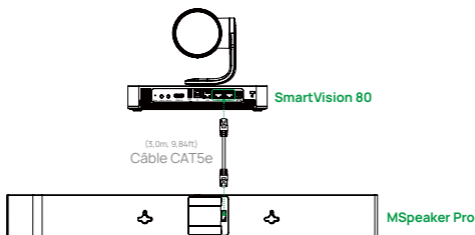

• Connexion multiple MSpeaker Pro

Connectez le MSpeaker Pro au port VCH de l'AVHub/SmartVision 80 via un câble Ethernet.

Connectez-vous à SmartVision 80

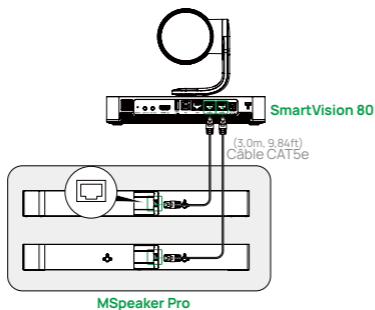

 Pour connecter plus de deux dispositifs MSpeaker Pro, le SmartVision 80 nécessite un commutateur PoE/PoE+ supplémentaire pour les dispositifs supplémentaires.

Connectez-vous à AVHub

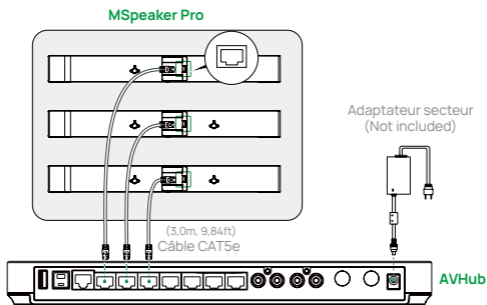

 Pour connecter plus de trois appareils MSpeaker Pro, l'AVHub nécessite un commutateur PoE/PoE+ supplémentaire pour les appareils supplémentaires.

Installation de MSpeaker Pro

- **Placement sur une surface plane**

Vous pouvez mettre le MSpeaker Pro sur la table de conférence.

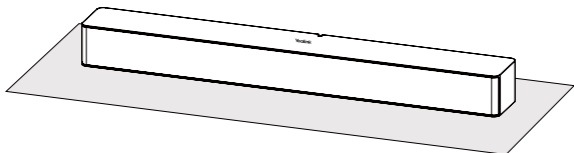

- **Monter sur un mur**

Installation horizontale

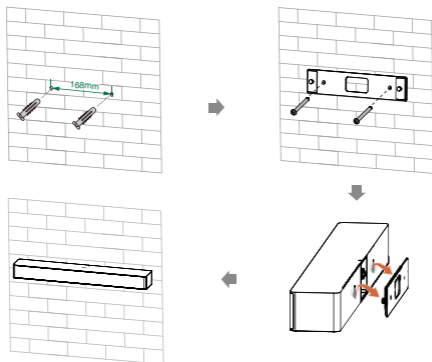

Installation verticale

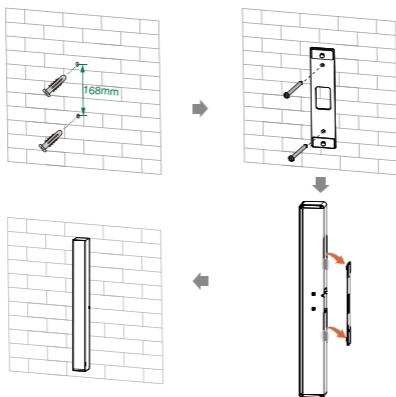

Instruction de l'indicateur LED

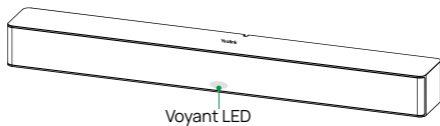

État des LED	Description
Désactivé	L'appareil est éteint.
Vert fixe	L'appareil est actif.
Rouge et vert clignotant alternativement	L'appareil est en cours d'initialisation.

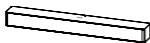

MSpeaker Pro



(L270*W50.0*T2.5mm)
Soporte de pared

 × 2
φ6 * 30 mm, blanco, Poliamida

 × 2
T4*30 FAHOZN3+ (+)



(7.5m, 24.60ft)
CAT5e UTP
Cable (RJ45 - RJ45)



Guía de inicio rápido

 Utilice siempre accesorios proporcionados o aprobados por Yealink. El uso de accesorios de terceros no aprobados puede resultar en un rendimiento deficiente.

Conexión MSpeaker Pro

• Conexión única de MSpeaker Pro

Conecta el MSpeaker Pro al puerto VCH del UVC84 / UVC86 / SmartVision 80 / AVHub a través de un cable Ethernet como dispositivo de salida de audio. El siguiente es un ejemplo de conexión al SmartVision 80.

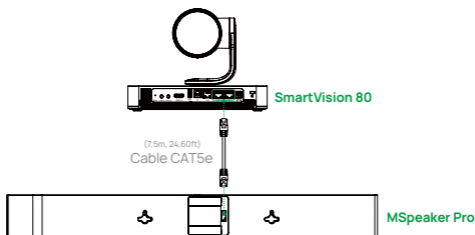

• Conexión múltiple de MSpeaker Pro

Conecta el MSpeaker Pro al puerto VCH del AVHub/SmartVision 80 a través de un cable Ethernet.

Conectarse a SmartVision 80

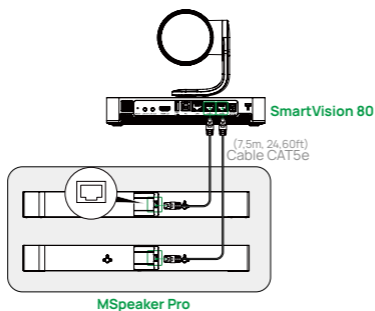

Para conectar más de dos dispositivos MSpeaker Pro, SmartVision 80 requiere un switch PoE/PoE+ adicional para los dispositivos sobrantes.

Conectar a AVHub

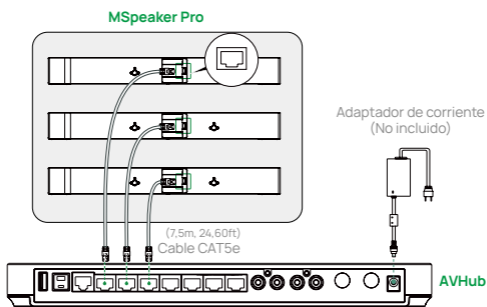

Para conectar más de tres dispositivos MSpeaker Pro, AVHub requiere un conmutador PoE/PoE+ adicional para los dispositivos sobrantes.

Instalación de MSpeaker Pro

- **Poner en superficie plana**

Puedes poner el MSpeaker Pro en la mesa de conferencias.

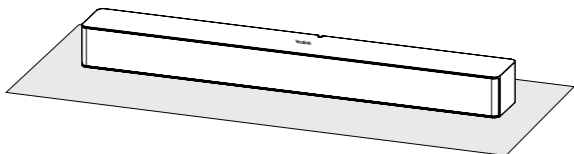

- **Montar en una pared**

Instalación horizontal

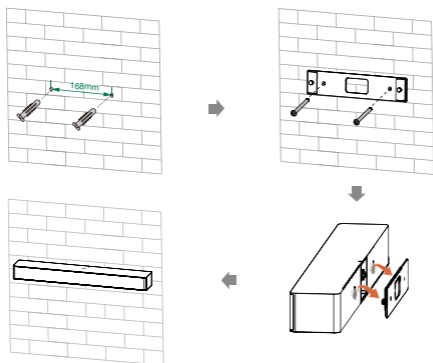

Instalación vertical

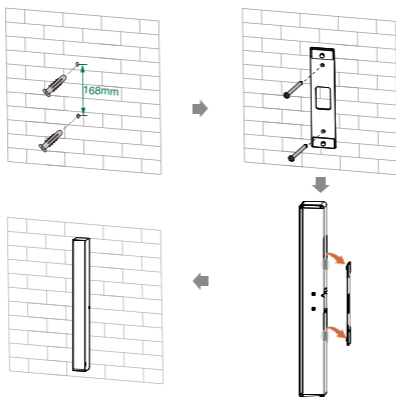

Instrucciones del indicador LED

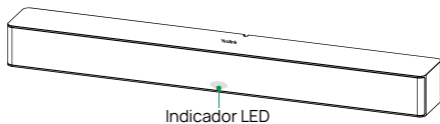

Estado de LED	Descripción
Apagado	El dispositivo está apagado.
Verde fijo	El dispositivo está activo.
Rojo y verde parpadeando alternativamente	El dispositivo está en inicialización.

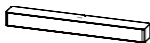

MSpeaker Pro



(L270*W50.0*T2.5mm)

Wandmontagebeugel



x 2

φ6 * 30 mm, wit, Polyamide



x 2

T4*30 FAHOZN3+ (+)



(3,0 m, 9,84 ft)

CAT5e UTP

(RJ45 - RJ45) Kabel



Beknopte handleiding

 Wij raden aan om de meegeleverde of goedgekeurde accessoires van Yealink te gebruiken. Het gebruik van niet-goedgekeurde accessoires van derden kan leiden tot slechte prestaties.

MSpeaker Pro Verbinding

• Enkele MSpeaker Pro-verbinding

Verbind de MSpeaker Pro met de VCH-poort van de UVC84 / UVC86 / SmartVision 80 / AVHub via een Ethernet-kabel als het audio-uitvoerapparaat. Het volgende is een voorbeeld van het verbinden met de SmartVision 80.

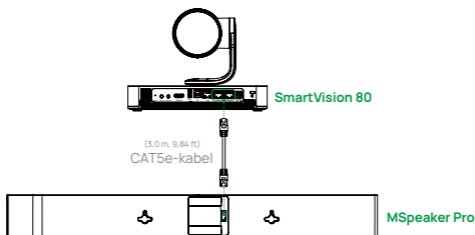

• Meerdere MSpeaker Pro-verbindingen

Verbind de MSpeaker Pro met de VCH-poort van de AVHub/SmartVision 80 via een Ethernet-kabel.

Verbind met SmartVision 80

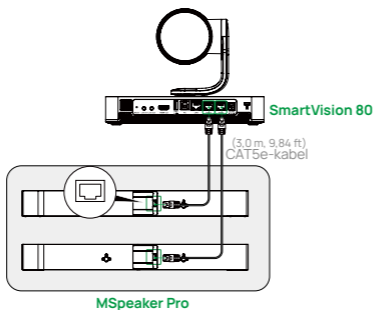

 Om meer dan twee MSpeaker Pro-apparaten te verbinden, heeft SmartVision 80 een extra PoE/PoE+-switch nodig voor de extra apparaten.

Verbind met AVHub

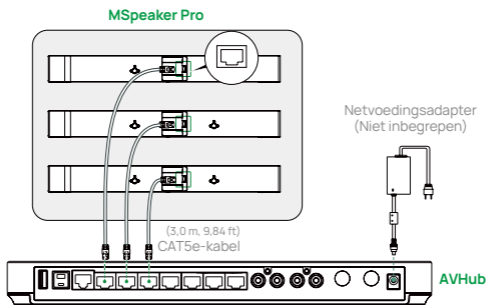

 Om meer dan drie MSpeaker Pro-apparaten te verbinden, heeft de AVHub een extra PoE/PoE+-switch nodig voor de extra apparaten.

MSpeaker Pro Installatie

- **Plaats op een vlakke ondergrond**

Je kunt de MSpeaker Pro op de vergadertafel zetten.

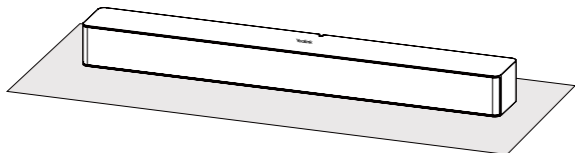

- **Op een muur monteren.**

Horizontale installatie

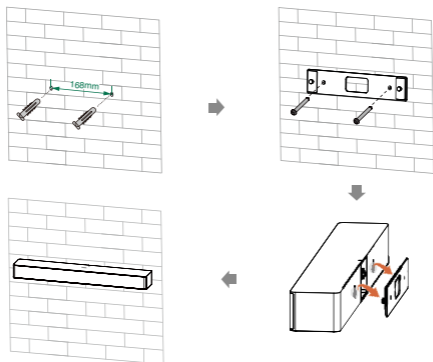

Verticale installatie

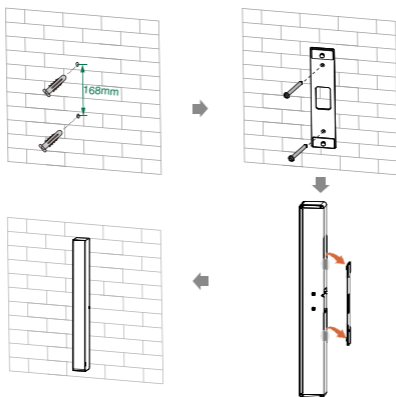

LED Indicator Instructie

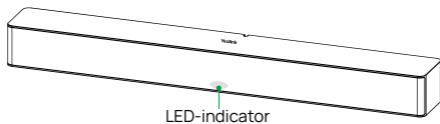

LED-status	Beschrijving
Uit	Het apparaat is uitgeschakeld.
Vast groen	Het apparaat is actief.
Rood en groen flitsen om de beurt	Het apparaat is aan het initialiseren.



Declaration of Conformity

We,

YEALINK(XIAMEN) NETWORK TECHNOLOGY CO.,LTD

Address: No.666 Hu'an Rd. Huli District Xiamen City, Fujian, P.R. China

Manufacturer: YEALINK(XIAMEN) NETWORK TECHNOLOGY CO.,LTD

Address: No.666 Hu'an Rd. Huli District Xiamen City, Fujian, P.R. China

DATE: 22nd/ April/2025

declare that the product

Type: Video Conferencing Soundbar

Model: MSpeaker Pro

meets the essential requirements and other relevant provisions according to the following EC directive

Directive: 2014/30/EU, 2014/35/EU

Conformity

The product complies with the following standards:

Safety : **EN 62368-1:2020+A11:2020**

EMC: **EN 55032:2015+A11:2020**

EN 55035:2017+A11:2020

EN IEC 61000-3-2: 2019+A1:2021

EN 61000-3-3: 2013+A1:2019

Harmonized: EN62321-1:2013

Directive 2011/65/EU and (EU)2015/863 of the European Parliament and of the Council of 8 June 2011 and 4 June 2015 on the restriction of the use of certain hazardous substances in electrical and electronic equipment(RoHS 2.0)

Directive 2012/19/EU of the European Parliament and of the Council of 4.July.2012 on Waste electrical and electronic equipment(WEEE)

Regulation (EC) No.1907/2006 of the European Parliament and of the Council of 18.December.2006 on Registration, Evaluation, Authorization, and Restriction of Chemicals (REACH)

The declaration of conformity is issued under the sole responsibility of the manufacturer

NAME: Huahu Wang

DATE:

TITLE: Manager

Huahu Wang

22/Apr/2025

About Yealink

Yealink (Stock Code: 300628) is a global-leading provider of Unified Communication & Collaboration Solutions specialized in video conferencing, voice communications, and collaboration, dedicated to helping every person and organization embrace the power of "Easy Collaboration, High Productivity".

With best-in-class quality, innovative technology, and user-friendly experiences, Yealink is one of the best providers in more than 140 countries and regions, ranks No.1 in the global market share of IP Phone, and is the Top 5 leader in the video conferencing market (Frost & Sullivan, 2021).

Technical Support

Visit Yealink WIKI (<http://support.yealink.com/>) for firmware downloads, product documents, FAQ, and more. For better service, we sincerely recommend you to use Yealink Ticketing system (<https://ticket.yealink.com>) to submit all your technical issues.



430104003105

YEALINK(XIAMEN) NETWORK TECHNOLOGY CO., LTD.
Web: www.yealink.com
Copyright©2025YEALINK(XIAMEN) NETWORK
TECHNOLOGY CO., LTD.All rights reserved.